

# Quick guide to maps for planning applications

A **planning map** is used when you're making a planning application. Location plans, site / block plans are essential items if you're submitting documents for planning permission, listed buildings, conservation area consent, prior notification applications, or land registration applications. Sometimes, planning maps are needed for connecting utilities and license applications.

Our custom planning maps start at £9.50 + VAT. They're all 100% compliant with current government planning guidelines. If you're a regular buyer, you may qualify for a discount.

We'll process your order quickly and email the results within minutes. There's no limit to how many times you can print the planning map and we have a customer support team who can help if you've made a mistake on your order.

## Can I see a planning map before buying it?

We make it easy to see what you are buying before you make a purchase. You can see our planning maps before you download them.

## Can I edit a planning map?

Yes, if you're ordering a planning map through Emapsite then you can edit it and mark it up before you download it - you can even add your own logo or project information.

## How to order a planning map

We make it easy to order a planning map for a planning application.

1. Go to [plans.emapsite.com](https://plans.emapsite.com)
2. Enter your postcode or title number and select your plan.

### a. A4 Location Plan 1:1250

### b. A4 Site / Block Plan 1:500

You can choose one, or both and decide if you'd like colour or black and white (there's no extra charge for colour). You can annotate your plan by adding a title and notes. Your personalisation will appear automatically.

3. Edit your plan with our drawing tools, choose your colour and line thickness.
4. Accept the licence / license agreements.
5. Add to basket and check out.

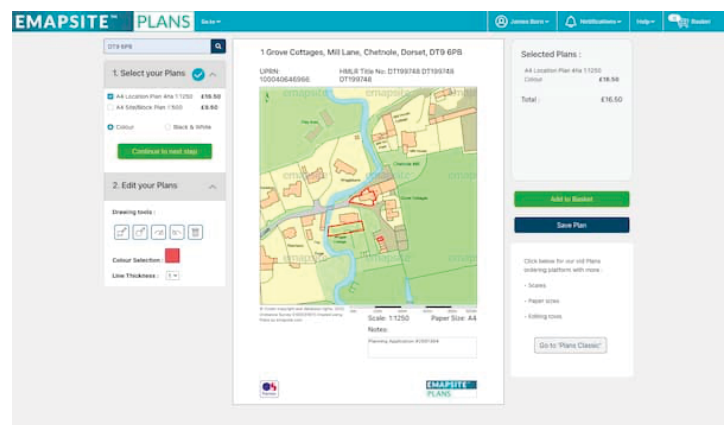

Emapsite plans website

# Quick guide to block plans

## What is a block plan?

**Block plans** are also known as site plans. If you're involved in a house build, you're adding an extension or undertaking a renovation, then you'll probably be asked for a block plan as part of the planning application process.

## When do I need a block plan?

### - Planning applications

Block plans are needed for a planning application, which is a request for permission to change what currently exists on a plot of land.

### - Listed building and conservation area consent

If you own a listed building and want to make changes to it, such as an alteration or an extension, you will need a block plan to get listed building consent.

### - Prior notification planning applications

These are made if you're extending an agricultural building, turning an office into a residential building, demolishing a building, installing renewable energy.

### - Land Registration application

If you're making an application to register ownership, then you'll need a block plan (remember, these are also known as site plans).

### - Connecting utilities

If your property needs new utilities or a change to the supply of utilities such as gas, electricity, or water, then you'll need a block plan.

### - License applications

Entertainment licenses, market operator licenses or felling.

## Block plan specifications

Block plans usually show a property's location in red. They'll also show the boundaries of the whole site and features immediately next to it, such as roads or nearby buildings.

Government guidance on 'Making an Application' states site / block plans must be identified with a metric scale and must show which way is North, too. Although not a requirement of legislation, the inclusion of a linear scale bar is also useful, particularly in the case of electronic submissions.

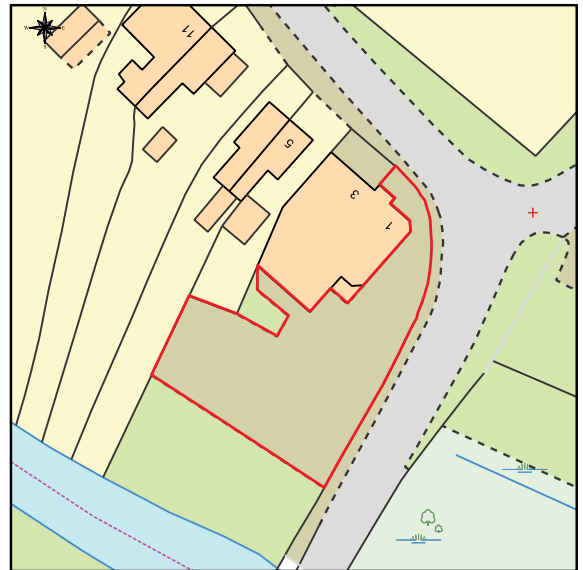

Example: Site / Block Plan  
at 1:500 Scale

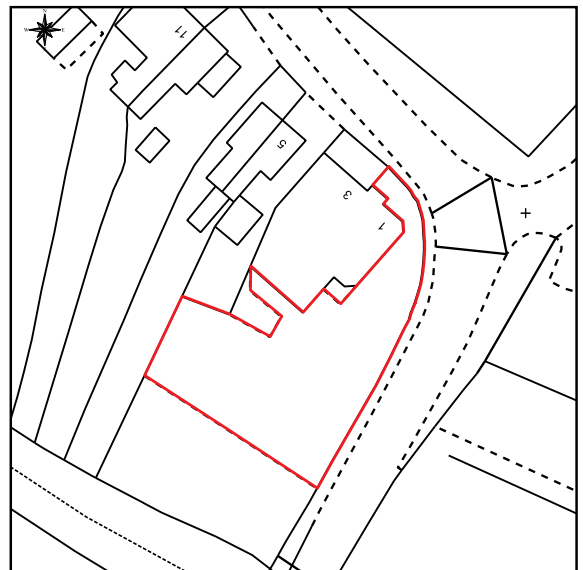

Example: Black & White Site / Block Plan  
at 1:500 Scale

## Site plans vs. Location plans vs. Floor plans

SITE / BLOCK PLANS	LOCATION PLANS	FLOOR PLANS
Site plans (also known as block plans) show the land that's involved in a planning application, and how a building relates to the physical boundary lines.	A location plan shows where you're proposing to develop land or buildings in relation to other surrounding properties and parcels of land.	A site plan is a view from above of the entire property, while a floor plan shows the building's footprint and includes the interior walls and features.

### Buying a site / block plan

You can create and buy site / block plans (and location plans) at [plans.emapsite.com](https://plans.emapsite.com). Use once as a 'lite' user, or register for a professional account.

You can add a range of markups to outline your property and other features (professionals can add a logo and other information). All site / block plans come complete with a North arrow and scale bar automatically. Your plan is free to edit after purchase and you can print it as many times as you'd like.

Our site plans process automatically and are delivered in minutes in a format that makes them easy to submit with planning applications.

Plans purchased at Emapsite are compliant with all current government planning guidelines. We are an Ordnance Survey Licensed Partner.



### Contact us

Telephone: +44 (0) 118 973 6883  
CustomerSupport@emapsite.com  
sales@emapsite.com

Building A2 (Office 1052)  
Cody Technology Park, Old Ively Road,  
Farnborough GU14 0LX

[www.emapsite.com](https://www.emapsite.com)

[plans.emapsite.com](https://plans.emapsite.com)

**EMAPSITE**<sup>TM</sup>

### Why buy your plans at Emapsite?

#### Free to view

We don't charge you for viewing the latest Ordnance Survey MasterMap (*subject to fair use policy*).

#### Edit after you've paid

Simply log in, make changes and download again.

#### We offer frequent buyer discounts

Regular buyers qualify, contact our customer support team (details left).

#### Mark up before downloading

Our sophisticated, easy to use, tools let you mark up your plan before downloading.